



9000 BTU / H (208/230V) WALL MOUNTED HEAT- PUMP SYSTEM

SUBMITTAL DATA: TW09HQ2C2D

Job Name	Location	Date
Purchaser	Engineer	
Submitted To	For	<input type="checkbox"/> Reference <input type="checkbox"/> Approval <input type="checkbox"/> Construction
Unit Designation	Schedule No.	

**AHRI CERTIFIED REF
NO: 9108745**



SYSTEM RATINGS			INDOOR UNIT DATA	
Cooling			Fan Motor	
Rated Capacity	9,000 BTU/H		Type	Cross-flow
Capacity Range	3,100-9,600 BTU/H		Output Power	20W
Power Input (Max)	1,300 W		FLA	0.1A
SEER	23.0		Air flow	
EER	14.0		Cooling Wet (Lo/Hi)	171/377 CFM
Heating at 47° F			Heating Dry (Lo/Hi)	171/377 CFM
Rated Capacity	11,000 BTU/H		Sound Level	
Capacity Range	1,911-12,000 BTU/H		Cooling (Min/Max)	29/43 db(A)
Power Input (Max)	1,350 W		Heating (Min/Max)	29/43 db(A)
HSPF	10.5		Dehumidification	1.69 pt/hr
COP	3.2		OUTDOOR UNIT DATA	
Heating at 17° F			Compressor	
Rated Capacity	6,800 BTU/H		Type	DC Inverter Driven Rotary
Operating Range			RLA	6.6 A
Cooling	(Max)	115°F (46°C)	Refrigerant Type	
	(Min)	0°F (-18°C)	Fan Motor	
Heating	(Max)	75°F (24°C)	Output Power	30 W
	(Min)	-4°F (-20°C)	FLA	0.36 A
REFRIGERANT PIPING DATA			Sound Level	
Gas Pipe Size (OD)	3/8-in		Cooling/Heating	53/53 db(A)
Liquid Pipe Size (OD)	1/4-in		ELECTRICAL DATA	
Connection Method	Flared		Power Supply	
Factory Charge	45.9 oz		Normal Operational Voltage	208/230 V, 1 Phase, 60 Hz
Additional Charge	0.16 oz/ft		Voltage Range	187 - 253 V
Pre-Charge Length	25-ft		MCA	9 A
MAX Refrigerant Pipe Length	49-ft		MOCP/Breaker Size	15 A
MIN Refrigerant Pipe Length	10-ft		Main Power Wire Size	14-2 AWG
MAX Refrigerant Pipe Elevation	33-ft			

GENERAL FEATURES

- Compact and Quiet Design
- High Efficiency DC Inverter Technology
- Wireless Remote with LCD Display
- Wi-Fi Ready (Sold Separately Kit PN: WSBE07)
- XK-41 Wired Tether Controller (Sold Separately)
- Low Ambient Cool to 0 deg F
- Blue Fin Condenser Coil



TOSOT.COM





FEATURES & FUNCTION SUMMARY: TW09HQ2C2D

SYSTEM FEATURES	
Inverter Type	G10
Ultra Low Frequency Torque Control	Yes
Power Factor Correction	Yes
Compressor Type	High Eff. Rotary
Refrigerant Type	R410A
Basepan With Electric Heater	NO
Compressor With Electric Heater	YES
Outdoor Fin Coating	Blue Fin
Intelligent Defrosting	YES
Intelligent Preheating	YES
Low Voltage Startup	YES
Memory/Power Failure Recovery	YES
Self Diagnosis	YES
Wired Controller Interface (XK-41)	YES
Wi-Fi Interface Capable	Optional (see PN: WSBEC07)
Indoor Fan Type	Crossflow
Multi Fan Speeds	4 Speeds
Indoor Unit Display	YES
Advance Filter	Optional (see Filter Kits)
Auxiliary Electrical Heater	NO
Ventilation (Outdoor Air)	NO
REMOTE CONTROLLER FUNCTIONS	
Auto Mode	YES
Auto Fan	YES
Auto Swing (Horizontal Auto Swing)	NO
Auto Swing (Vertical Auto Swing)	YES
Clock on Remote Controller	YES
Dry Mode	YES
Dry Anti-Mildew (X-Fan) Mode	NO
Energy Saving Mode	YES
Dirty Filter Alert	NO
I Feel Function	YES
Lock on Remote Controller	YES
Quiet Mode	NO
Room Temperature Display	YES
Sleep Mode	YES
4 Sleep Modes Options	NO
Timer Mode	YES
Turbo Mode	YES
Display On/Off Control	YES
Freeze Guard Mode	YES
Display On/Off Control	YES
Freeze Guard Mode	YES

EXTENDED & RATINGS: TW09HQ2C2D

COOLING PERFORMANCE (BtuH)*

Outdoor Ambient DB	Indoor Ambient Temperature							
	68°F DB (20°C)		73°F DB (23°C)		80°F DB (27°C)		82°F DB (28°C)	
	57°F WB (14°C)		61°F WB (16°C)		67°F WB (19°C)		68°F WB (20°C)	
	TC	SHC	TC	SHC	TC	SHC	TC	SHC
5°F	5,748	4,508	6,073	4,761	6,854	5,375	6,914	5,423
14°F	5,896	4,624	6,226	4,883	7,115	5,579	7,178	5,629
23°F	6,298	4,940	6,736	5,284	7,719	6,054	7,787	6,108
32°F	7,637	5,990	8,169	6,407	8,947	7,015	9,026	7,077
41°F	8,650	6,784	9,190	7,207	9,821	7,703	9,908	7,771
50°F	8,547	6,705	9,091	7,131	9,731	7,633	9,817	7,700
59°F	8,337	6,538	8,878	6,963	9,641	7,563	9,726	7,630
68°F	8,127	6,373	8,668	6,799	9,461	7,420	9,545	7,486
77°F	7,920	6,212	8,457	6,632	9,280	7,280	9,363	7,344
86°F	7,692	6,033	8,229	6,452	9,010	7,067	9,090	7,130
95°F	7,505	5,887	8,040	6,306	8,893	6,976	8,972	7,038
104°F	7,319	5,740	7,854	6,160	8,776	6,884	8,854	6,945
113°F	6,944	5,445	7,478	5,865	8,403	6,589	8,478	6,648

HEATING PERFORMANCE (BtuH)*

Outdoor Ambient DB	Indoor Ambient Temperature							
	68°F DB (20°C)		73°F DB (23°C)		80°F DB (27°C)		86°F DB (30°C)	
	57°F WB (14°C)		61°F WB (16°C)		67°F WB (19°C)		72°F WB (22°C)	
	TC	SHC	TC	SHC	TC	SHC	TC	SHC
-4°F	5,772	5,772	5,717	5,717	5,620	5,620	5,393	5,393
0°F	6,253	6,253	6,194	6,194	6,091	6,091	5,840	5,840
6°F	6,597	6,597	6,535	6,535	6,425	6,425	6,160	6,160
10°F	6,872	6,872	6,806	6,806	6,693	6,693	6,418	6,418
16°F	7,078	7,078	7,013	7,013	6,896	6,896	6,610	6,610
19°F	7,219	7,219	7,147	7,147	7,030	7,030	6,738	6,738
24°F	8,020	8,020	7,951	7,951	7,831	7,831	7,542	7,542
32°F	8,955	8,955	8,886	8,886	8,766	8,766	8,477	8,477
41°F	10,024	10,024	9,955	9,955	9,838	9,838	9,546	9,546
43°F	10,292	10,292	10,223	10,223	10,103	10,103	9,814	9,814
47°F	11,223	11,223	11,110	11,110	10,918	10,918	10,443	10,443
53°F	11,337	11,337	11,220	11,220	11,024	11,024	10,546	10,546
59°F	11,595	11,595	11,478	11,478	11,275	11,275	10,787	10,787
64°F	11,842	11,842	11,722	11,722	11,516	11,516	11,017	11,017
70°F	12066	12066	11942	11942	11736	11736	11227	11227
75°F	12234	12234	12110	12110	11897	11897	11382	11382

* Maximum system capacity TC- Total Capacity (BtuH) SHC- Sensible Capacity (BtuH)



DIMENSIONAL SPECIFICATIONS: TW09HQ2C2D

MINIMUM SPACING REQUIREMENTS

INDOOR

Units: inch (mm)

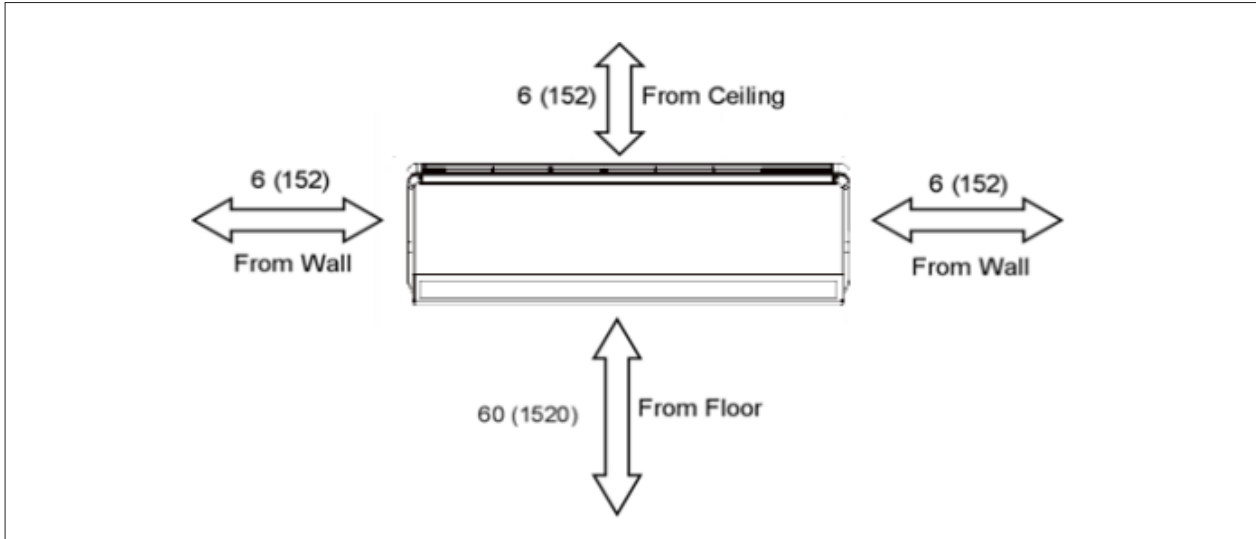

OUTDOOR

Units: inch (mm)

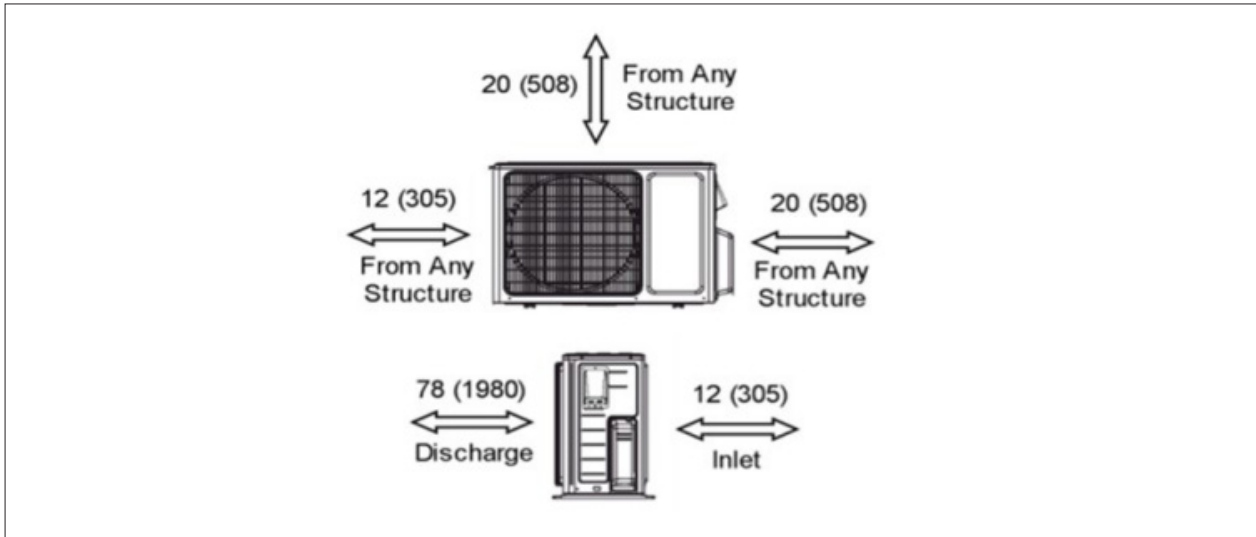

TOSOT

DIMENSIONAL SPECIFICATIONS: TW09HQ2C2D

INDOOR UNIT DIMENSIONS

Model No: TW09HQ2C2DI

Units: inch

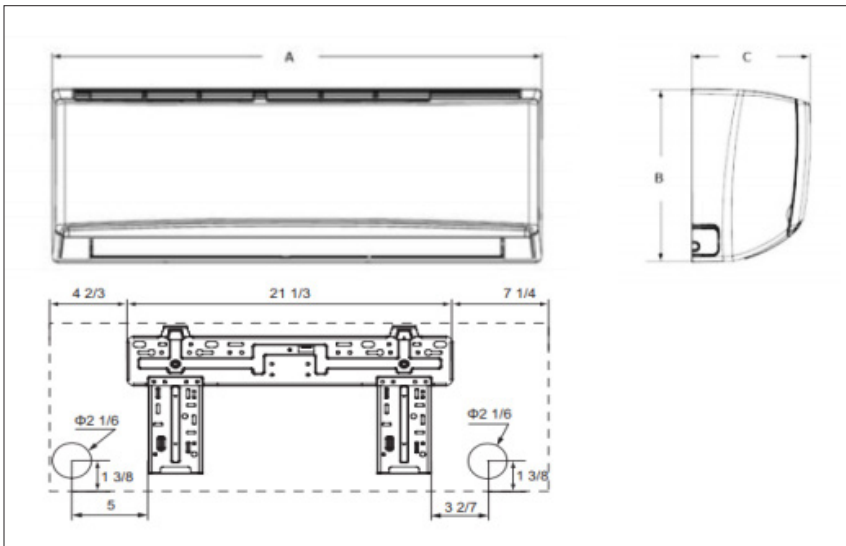

Dimensions	
A	33.4
B	11.4
C	8.2

Weight (Net/Gross) 22.1/26.5 lbs

Liquid Line Valve	1/4 in OD Flared
Gas Line Valve	3/8-in OD Flared
Drain Connector	5/8-in OD

OUTDOOR UNIT DIMENSIONS

Model No: TW09HQ2C2DO

Units: inch

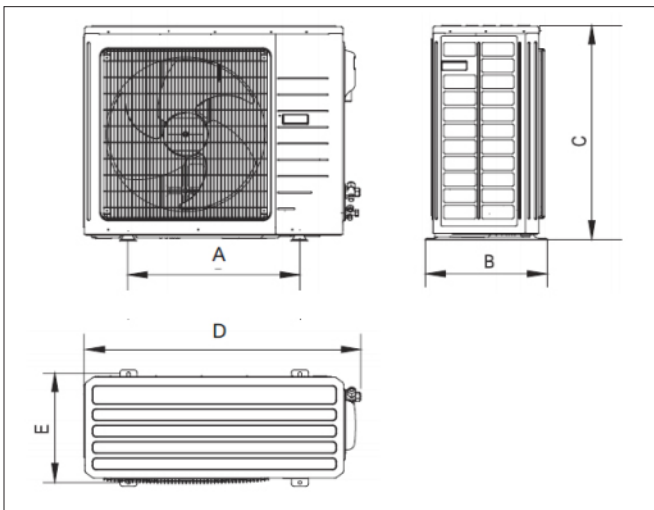

Dimensions	
A	21.3
B	12.6
C	21.3
D	33.4
E	11.3

Weight (Net/Gross) 78.0/84.0 lbs

Liquid Line Valve	1/4 in OD Flared
Gas Line Valve	3/8-in OD Flared

Notes:

1. Recommended Interconnecting Cable Type 14 AWG 4 Stranded Copper Conductors Wire.
2. Power wiring cable size must comply with applicable national and local codes.
3. Test conditions are based on AHRI 210/240.

TOSOT.COM

