

**TOSOT**

**HEAT / COOL**  
**DAILY CHARMING, COOLING CHARMO**

**12,000 BTU / H WALL MOUNTED HEAT- PUMP SYSTEM**

**SUBMITTAL DATA: TW12HXCA5D**

Job Name	Location	Date
Purchaser	Engineer	
Submitted To	For	<input type="checkbox"/> Reference <input type="checkbox"/> Approval <input type="checkbox"/> Construction
Unit Designation	Schedule No.	

**AHRI CERTIFIED REF  
 NO: 211177538**



SYSTEM RATINGS			INDOOR UNIT DATA	
<b>Cooling</b>			<b>Fan Motor</b>	
Rated Capacity at 95° F	12,000 BTU/H	Type	Cross-flow	
Capacity Range	2,388-13,307BTU/H	Output Power	15W	
Power Input	1,380 W	FLA	0.40A	
Power Input (Min/Max)	180/1,500 W	Fan Speeds	7	
SEER / SEER2	17.5 / 17.5	Air flow (Min/Max)	182/424 CFM	
EER / EER2	10.05 / 10.05	<b>Sound Pressure Level</b>		
<b>Heating</b>			Cooling (Low/High)	27/47 dB(A)
Rated Capacity at 47° F	12,000 BTU/H	Heating (Low/High)	27/47 dB(A)	
Capacity Range	2,388-15,013 BTU/H	<b>Dehumidification</b>	2.96 pt/hr	
Power Input	1,004 W	<b>OUTDOOR UNIT DATA</b>		
Power Input (Min/Max)	260 / 1,650W	<b>Compressor</b>		
HSPF/HSPF2	10.0 / 8.5	Type	DC Inverter Driven, Rotary	
COP	3.50	RLA	7.30 A	
			<b>Fan Motor</b>	
			Output Power	30 W
			RLA	0.6 A
<b>Operating Range</b>			<b>Sound Pressure Level</b>	
Cooling	(Max)	115°F (46°C)	52 dB(A)	
	(Min)	0°F (-18°C)	<b>Refrigerant Piping Data</b>	
Heating	(Max)	75°F (24°C)	Liquid Pipe Size (OD)	1/4-in
	(Min)	-4°F (-20°C)	Gas Pipe Size (OD)	3/8-in
<b>Power Supply</b>			Connection Method	Flared
Normal Operational Voltage	208/230 V, 1 Phase, 60 Hz	Factory Charge	R410A/27.5 oz	
Voltage Range	187 - 253 V	Additional Charge	0.215 oz/ft	
Main Power Wire Size	14-2 AWG	Pre-Charge Length	24.6-ft	
Interconnecting Cable Wire Size	14-4 AWG	MAX Refrigerant Pipe Length	65.6-ft	
MCA	11A	MIN Refrigerant Pipe Length	10-ft	
MOCP/Max Breaker Size	15 A	MAX Refrigerant Pipe Height Difference	32.8-ft	

**GENERAL FEATURES**

- Easy Installation and cleaning
- Self Cleaning function
- Fast Cooling With Meticulous Care
- WIFI Included
- 3D Airoutlet
- Wired Controller (Sold Separately) XK19
- 7 Indoor Fan Speeds
- Copper Tube/Aluminum Fins w/Acrylic Resin Anti-Corrosion both inside and out
- Outdoor Temperature Display
- I-FEEL Function

**TOSOT.COM**



## FEATURES & FUNCTION SUMMARY: TW12HXCA5D

SYSTEM FEATURES	
Ultra Low Frequency Torque Control	Yes
Power Factor Correction	Yes
Compressor Type	High Eff. Rotary
Refrigerant Type	R410A
Basepan With Electric Heater	YES
Compressor With Electric Heater	YES
Indoor & Outdoor Fin Coating (Blue)	Acrylic Resin/Anti-Corrosion
Intelligent Defrosting	YES
Intelligent Preheating	YES
Low Voltage Startup	YES
Memory/Power Failure Recovery	YES
Self Diagnosis	YES
Wired Controller Interface	YES
WIFI Included	YES
Indoor Fan Type	Cross-flow
Multi Fan Speeds	7 Speeds
Indoor Unit Display	YES
Auxiliary Electrical Heater	NO
Outdoor Temperature Display	YES
Auxiliary Electrical Heater	NO
Auto Mode	YES
Auto Fan	YES
Auto Swing (Horizontal Auto Swing)	NO
Auto Swing - 180°(Vertical Auto Swing)	YES
Clock on Remote Controller	YES
Dry Mode	YES
Dry Anti-Mildew (X-Fan) Mode	YES
Energy Saving Mode	YES
Dirty Filter Alert	NO
Fan Speed Control (7 speeds)	YES
I Feel Function	YES
Privacy Lock on Remote Controller	YES
Quiet Mode	YES
Room Temperature Display	YES
Sleep Mode	YES
Sleep Modes Options	YES
Timer Mode	YES
Turbo Mode	YES
Display On/Off Control	YES
Freeze Guard Mode	NO
Power Failure Mode	YES



## EXTENDED RATINGS: TW12HXP2A1D

### COOLING PERFORMANCE

Outdoor Ambient Temperature (DB)	Return Air Temperature																				
	68°F (DB) / 57°F (WB)					73°F (DB) / 61°F (WB)					80°F (DB) / 67°F (WB)					90°F (DB) / 73°F (WB)					
	TC (Btu/h)	SC (Btu/h)	SHR	EER	Power Input (W)	TC (Btu/h)	SC (Btu/h)	SHR	EER (Btu/(h·W))	Power Input (W)	TC (Btu/h)	SC (Btu/h)	SHR	EER (Btu/(h·W))	Power Input (W)	TC (Btu/h)	SC (Btu/h)	SHR	EER (Btu/(h·W))	Power Input (W)	
<b>MAX OUTPUT*</b>	0°F	4288.4	3109.1	73%	5.0	862.8	5297.5	3840.7	73%	5.8	908.2	6306.5	4540.7	72%	6.6	956.0	6550.5	4749.1	72%	6.7	984.5
	5°F	4919.1	3590.9	73%	5.5	901.4	5928.1	4327.5	73%	6.2	948.8	6937.2	5064.2	73%	6.9	998.8	7205.6	5260.1	73%	7.0	1027.3
	14°F	5549.7	4079.0	73%	6.1	914.3	6558.8	4820.7	73%	6.8	962.4	7567.8	5524.5	73%	7.5	1013.0	7860.6	5777.5	73%	7.3	1070.1
	23°F	5802.0	4293.5	74%	6.0	965.8	6811.0	5040.1	74%	6.7	1016.6	7820.1	5786.9	74%	7.3	1070.1	8122.6	6010.7	74%	7.5	1084.4
	32°F	6054.2	4510.4	75%	6.0	1004.4	7063.3	5262.2	75%	6.7	1057.3	8072.3	5973.5	74%	7.3	1112.9	8384.6	6246.5	74%	7.3	1155.7
	41°F	6811.0	5108.3	75%	6.6	1030.1	7820.1	5865.1	75%	7.2	1084.4	8829.1	6621.8	75%	7.7	1141.4	9170.7	6878.0	75%	7.7	1198.5
	50°F	7567.8	5713.7	76%	6.9	1094.5	8576.8	6475.5	76%	7.4	1152.1	9585.9	7285.3	76%	7.9	1212.8	9956.8	7517.4	76%	8.0	1241.3
	59°F	8072.3	6134.9	76%	7.1	1133.2	9081.4	6901.9	76%	7.6	1192.8	10090.4	7668.7	76%	8.0	1255.6	10480.8	7965.4	76%	8.2	1284.1
	68°F	8450.7	6464.8	77%	7.2	1171.8	9459.8	7236.7	76%	7.7	1233.5	10468.8	8061.0	77%	8.1	1298.4	10873.8	8318.5	77%	8.2	1326.9
	77°F	10594.9	8158.1	77%	8.4	1261.9	11604.0	8935.1	77%	8.7	1328.4	12613.0	9712.0	77%	9.0	1398.3	13101.0	10087.8	77%	9.7	1355.5
	86°F	11730.1	9090.8	77%	8.8	1326.3	12739.1	9872.8	77%	9.1	1396.1	13748.2	10723.6	78%	9.4	1469.6	14280.1	11067.1	78%	10.3	1384.0
	95°F	10594.9	8264.0	78%	8.2	1287.7	11604.0	9051.1	78%	8.6	1355.5	12613.0	9838.1	78%	8.8	1426.8	13101.0	10218.8	78%	8.9	1469.6
104°F	9333.6	7326.9	79%	8.2	1133.2	10342.7	8119.0	78%	8.7	1192.8	11351.7	8967.8	79%	7.7	1481.3	11790.9	9255.9	79%	7.9	1498.0	
113°F	8576.8	6775.7	79%	8.2	1043.0	9585.9	7572.9	79%	8.7	1097.9	10594.9	8370.0	79%	7.3	1446.7	11004.8	8693.8	79%	7.3	1512.2	

\*Maximum Output values are not based on AHRI test conditions

<b>LEGEND:</b>	<b>W - Watts</b>
	<b>DB - Dry Bulb</b>
	<b>TC - Total Capacity</b>
	<b>SC - Sensible Capacity</b>
	<b>SHR - Sensible Heat Ratio</b>
	<b>COP - Coefficient of Performance</b>



## EXTENDED RATINGS: TW12HXP2A1D

HEATING PERFORMANCE													
Outdoor Ambient Temperature (DB)	Return Air Temperature												
	70°F (DB) / 59°F (WB)			75°F (DB) / 63°F (WB)			80°F (DB) / 67°F (WB)			90°F (DB) / 73°F (WB)			
	TC (Btu/h)	COP (W/W)	Power Input (W)	TC (Btu/h)	COP (W/W)	Power Input (W)	TC (Btu/h)	COP (W/W)	Power Input (W)	TC (Btu/h)	COP (W/W)	Power Input (W)	
<b>MAX OUTPUT*</b>	-4°F	7206	1.91	1106	7507	1.95	1128	7807	1.99	1151	8107	2.02	1174
	0°F	8257	2.15	1128	8557	2.18	1151	8858	2.21	1174	9158	2.24	1198
	6°F	8708	2.22	1152	9008	2.25	1175	9308	2.28	1198	9608	2.30	1222
	10°F	9008	2.25	1175	9308	2.28	1199	9608	2.30	1222	9909	2.33	1247
	16°F	10009	2.45	1199	10309	2.47	1223	10609	2.49	1247	10909	2.51	1272
	19°F	10708	2.57	1223	11008	2.59	1248	11308	2.60	1273	11608	2.62	1298
	24°F	11260	2.64	1248	11560	2.66	1273	11860	2.68	1299	12161	2.69	1325
	32°F	11410	2.62	1274	11710	2.64	1299	12010	2.66	1325	12311	2.67	1352
	41°F	14262	3.22	1300	14563	3.22	1326	14863	3.22	1352	15163	3.22	1379
	43°F	14713	3.25	1326	15013	3.25	1353	15313	3.25	1380	15614	3.25	1408
	47°F	15013	3.25	1354	15313	3.25	1381	15614	3.25	1408	15914	3.25	1436
	53°F	15163	3.19	1394	15463	3.19	1422	15764	3.19	1450	16064	3.18	1479
	59°F	15313	3.13	1436	15614	3.12	1465	15914	3.12	1494	16214	3.12	1524
	64°F	15764	3.12	1479	16064	3.12	1509	16364	3.12	1539	16664	3.11	1570
70°F	16214	3.12	1523	16514	3.11	1554	16815	3.11	1585	17115	3.10	1617	
75°F	16664	3.11	1569	16965	3.11	1600	17265	3.10	1632	17565	3.09	1665	

\*Maximum Output values are not based on AHRI test conditions

<b>LEGEND:</b>	<b>W - Watts</b>
	<b>DB - Dry Bulb</b>
	<b>TC - Total Capacity</b>
	<b>SC - Sensible Capacity</b>
	<b>SHR - Sensible Heat Ratio</b>
	<b>COP - Coefficient of Performance</b>

**DIMENSIONAL SPECIFICATIONS: TW12HXCA5D**

**MINIMUM SPACING REQUIREMENTS**

**INDOOR**

Units: inch (mm)

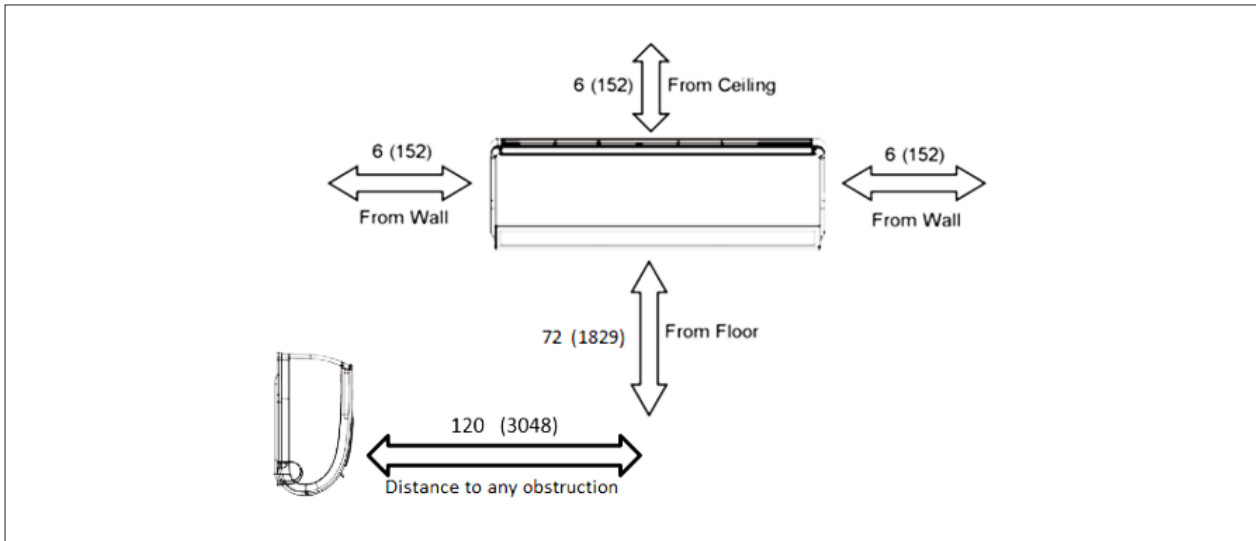

**MINIMUM OUTDOOR CLEARANCES**

Units: inch (mm)

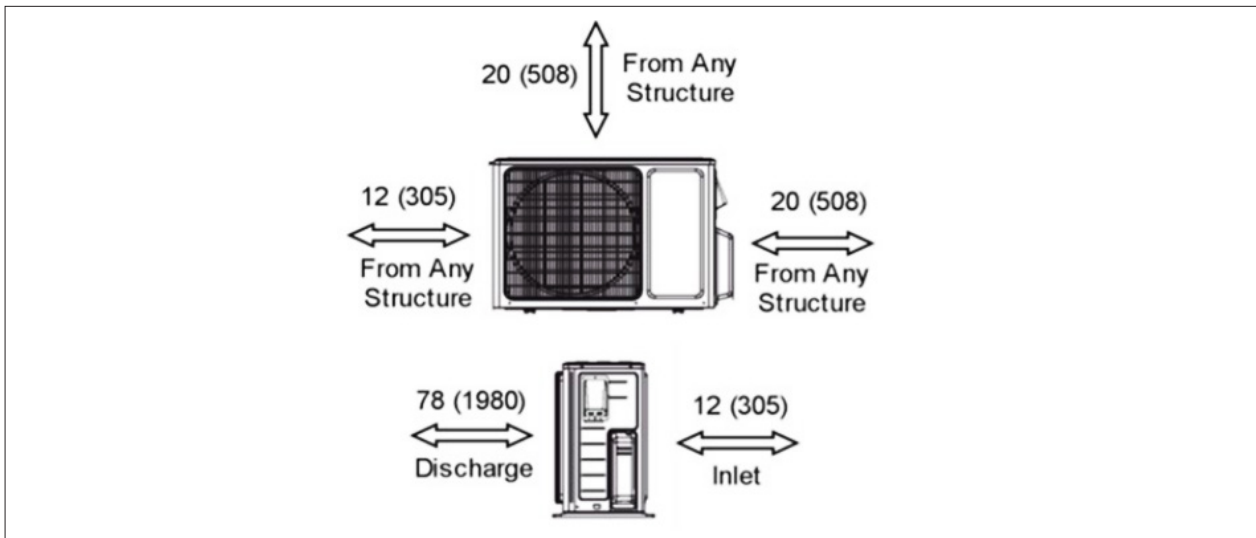

**TOSOT**

## DIMENSIONAL SPECIFICATIONS: TW12HXCA5D

### INDOOR UNIT DIMENSIONS

Model No: TW12HXCA5DI

Units: inch

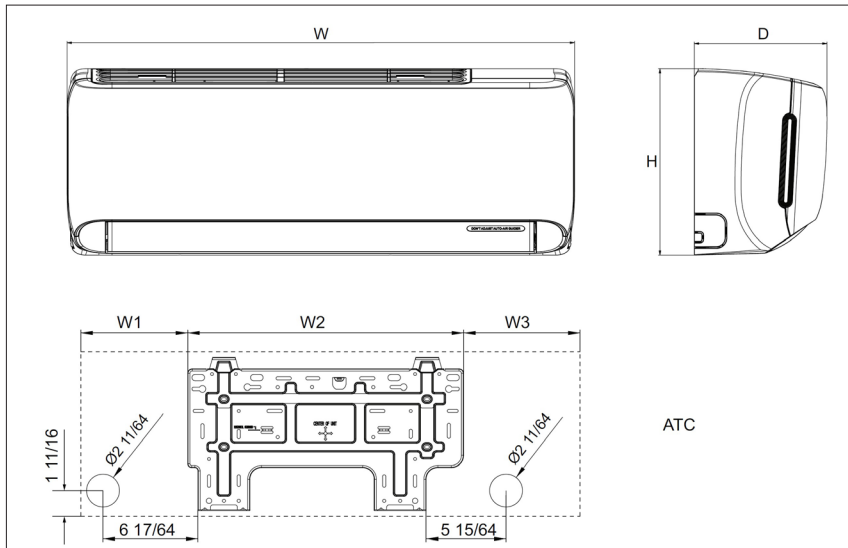

Dimensions	
D	$7 \frac{7}{8}$
H	$10 \frac{53}{64}$
W	$32 \frac{7}{8}$
W1	$7 \frac{3}{64}$
W2	$18 \frac{5}{32}$
W3	$7 \frac{11}{16}$

**Weight (Net/Shipping) 19.8 / 24.3 LBS**

Liquid Line Valve	1/4-in OD Flared
Gas Line Valve	3/8-in OD Flared
Drain Connector	5/8-in OD

### OUTDOOR UNIT DIMENSIONS

Model No: TW12HXCA5DO

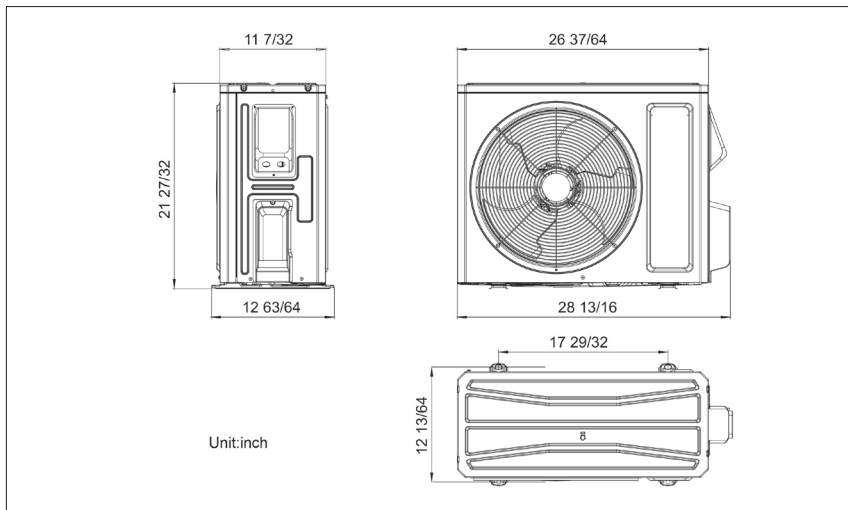

**Weight (Net/Shipping) 57.3 / 62.8 LBS**

Liquid Line Valve	1/4-in OD Flared
Gas Line Valve	3/8in OD Flared

Notes:

1. Recommended Interconnecting Cable Type 14 AWG 4 Stranded Copper Conductors Wire.
2. Power wiring cable size must comply with applicable national and local codes.
3. Test conditions are based on AHRI 210/240.